

News Letter_February.2018_Monthly news

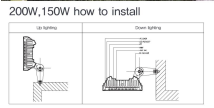

Daika Buyer, who had a meeting with Japan Trade Mission in September last year, visited us on the 2nd of last week and held in-depth conversations.
 Before the visit, they tested the product twice a sample of us already confirmed the detailed specification of the actual production product and proceed the production site too.
 We will supply waterproof LED lighting for machine tools customized to the facility in the near future.



LED Flood lighting 150W
 Big space lighting 150W
 100% waterproof, lamp proof, Anti-poll
 All color footcandle L&L supported in the same
 beam, warm white and cool white

Model No.	Beam angle	CR	CCT
TL1500W	150°/180°	Over 90	5000K
TL1500W	150°/180°	Over 90	6000-3000K

Converter	Input	Power	PF	Efficiency	Color
150W	AC 220V-240V/50/60Hz	150W	Over 0.95	90%	Warm White

IP level	K. level	Weight	Working temperature	Material	Color
IP65	K10	1.2kg	-40~+50°C	AL, EPOXY	White, Customized

LED Flood lighting 200W
 Big space lighting 200W
 100% waterproof, lamp proof, Anti-poll
 All color footcandle L&L supported in the same
 beam, warm white and cool white

Model No.	Beam angle	CR	CCT
TL2000W	150°/180°	Over 90	5000K
TL2000W	150°/180°	Over 90	6000-3000K

Converter	Input	Power	PF	Efficiency	Color
200W	AC 220V-240V/50/60Hz	200W	Over 0.95	90%	Warm White

IP level	K. level	Weight	Working temperature	Material	Color
IP65	K10	1.2kg	-40~+50°C	AL, EPOXY	White, Customized



